



# cair app setup and Wi-Fi configuration guide

Use this when setting up your sensor for the first time.

Also includes a guide on how to re-configure your Wi-Fi settings.

For iOS iPhones / iPad



Part 1: cair app setup guide

Part 2: App configuration with new Wi-Fi settings

For issues not covered in this guide please e-mail [support@cairsensors.com](mailto:support@cairsensors.com)



## Part 1: cair app setup guide

### Step 1:

#### Download App from the App Store

- Go to the App list on your phone and search for 'App Store' app
- Open the app store app and search for cair sensor
- Open the app listed and press on 'Get', then install and then open the app



### Step 2:

#### Setup an Account

Once you have opened the app and reviewed the privacy policy and Terms and Conditions please press 'Create Account' button and complete your details.

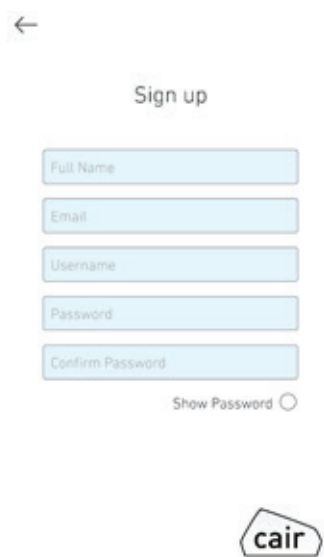



### Step 3:

The instructions screen will appear. You will now need to leave the app and connect to your cair sensor by connecting to the NuWave Sensors Wi-Fi network. Once this is completed you can return to the app.

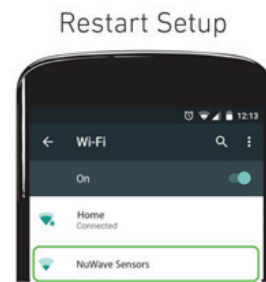

- a. Leave the cair app & go to WiFi Settings
- b. Connect to NuWaveSensor network. If not available, use the reset pin, press and hold reset button for 8 seconds
- c. Return to cair app & click button below



### Step 4:

Select NuWave Sensor from the list and press to connect to it

Note:

If you do not see 'NuwaveSensor' on your list of Wi-Fi networks your sensor may not be correctly reset. Please see the last page of this document for a guide on how to reset your sensor.

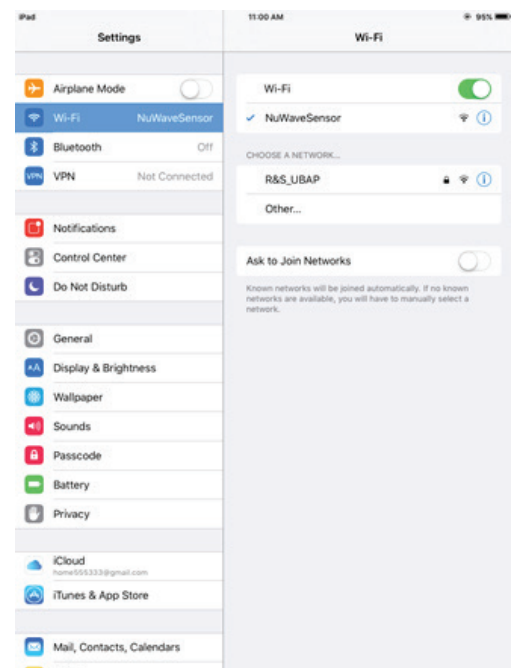

You should see the network status as 'connected'

Step 5:

Select your Wi-Fi network from the list and press next.

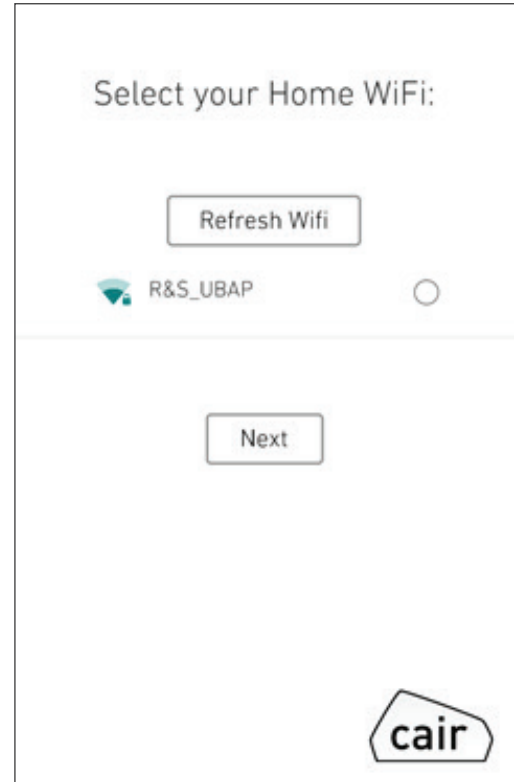

Once selected, you will be prompted to enter your Wi-Fi password. Enter this and press 'Next'

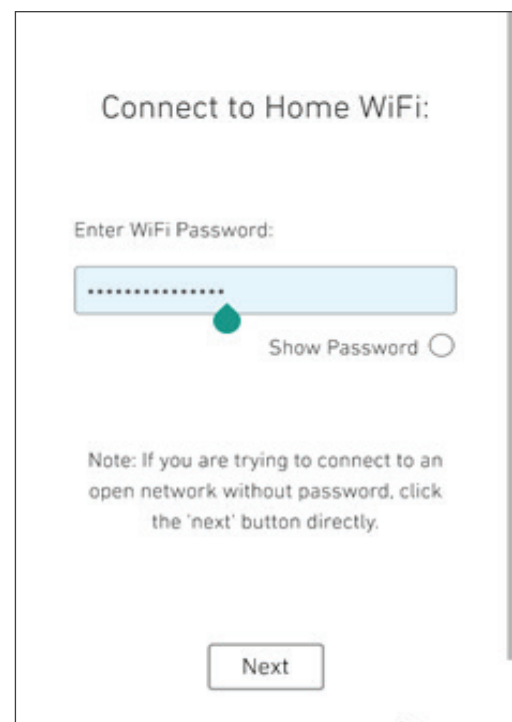



## Step 6:

The app will now automatically connect to your Wi-Fi network



You should see the following message once it has completed. As you have re-connected it will take 5 minutes to display data on your app dashboard. You will see the following screens.

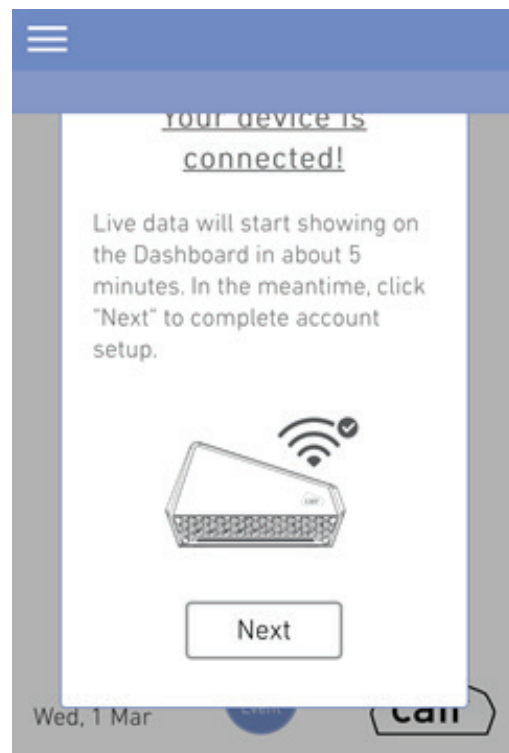



Next, follow the below quick steps to finish the sensor setup.

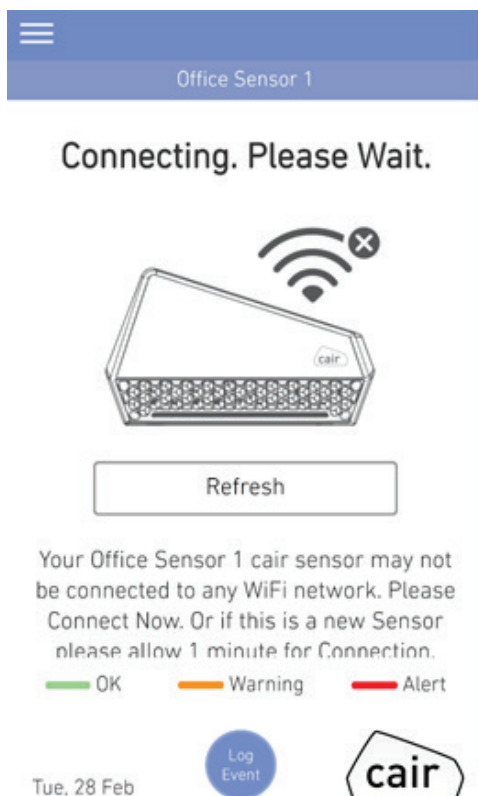
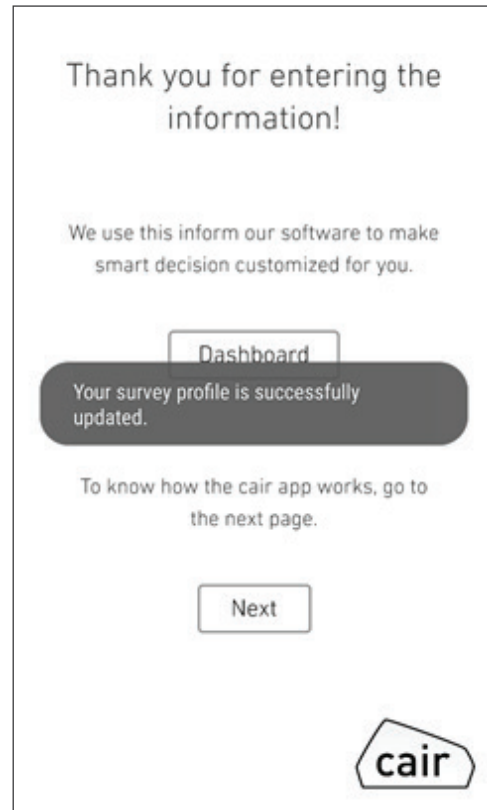
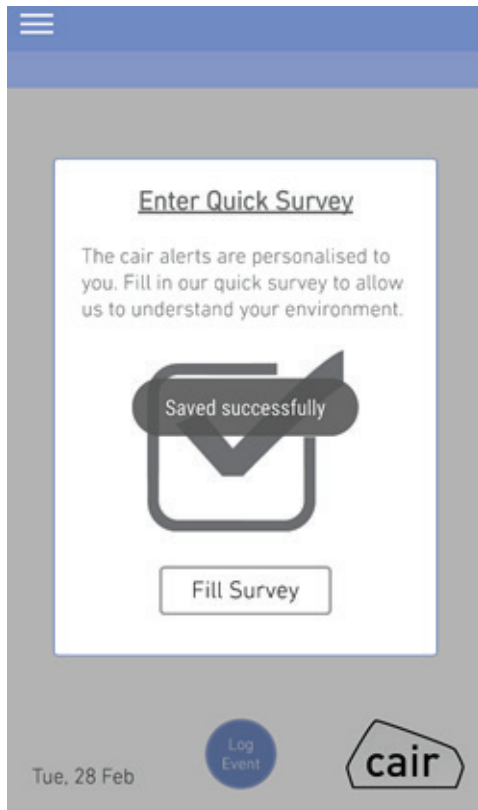

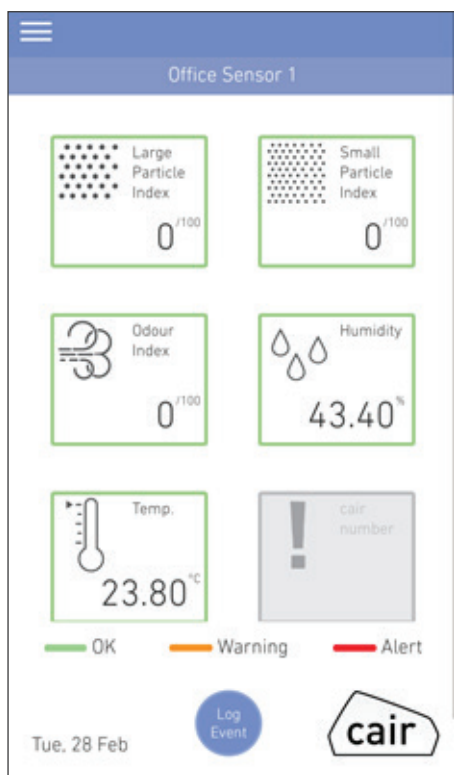

You should now have completed setup.

If you have any issues during setup, please contact: [support@cairsensors.com](mailto:support@cairsensors.com)

## Part 2: App configuration with new Wi-Fi settings

### Step 1:

While the device is powered ON.

Using the reset pin provided – insert the pin and press and hold the reset button for 8 seconds.

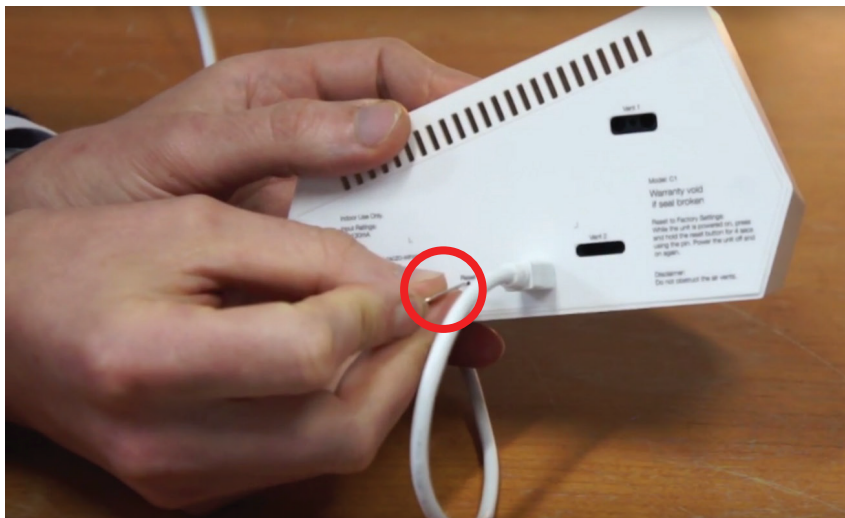

Once this has been completed power the device off and on by unplugging it and plugging it in again.

### Step 2:

When logged into the app, please select Device Settings from the menu

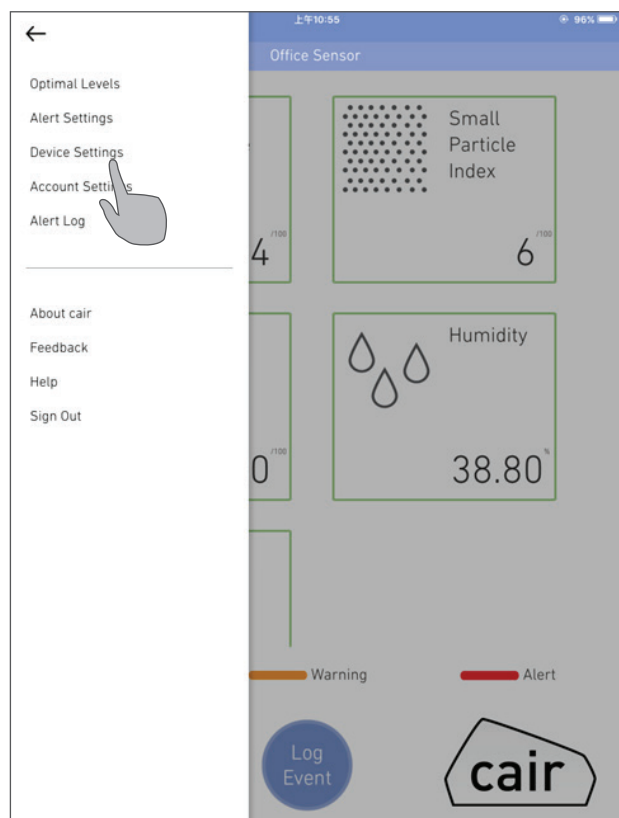





Step 3:  
From the menu please  
select the Reconfigure  
Device Wi-Fi button

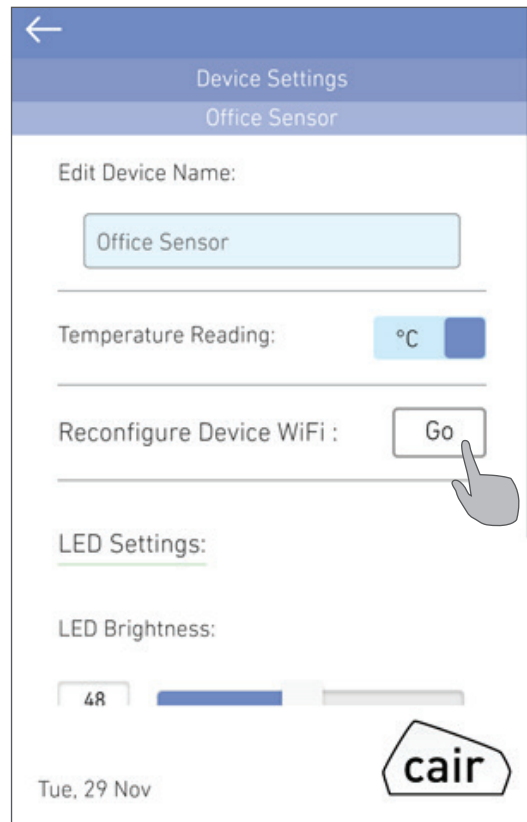

Step 4:  
Select 'Reconfigure Now'

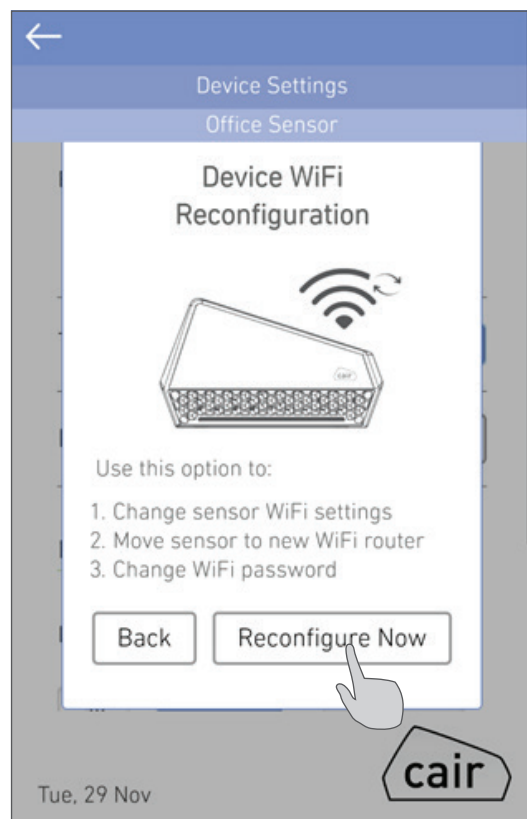

Step 5:  
Select 'Next' as shown  
on the screen on the  
left

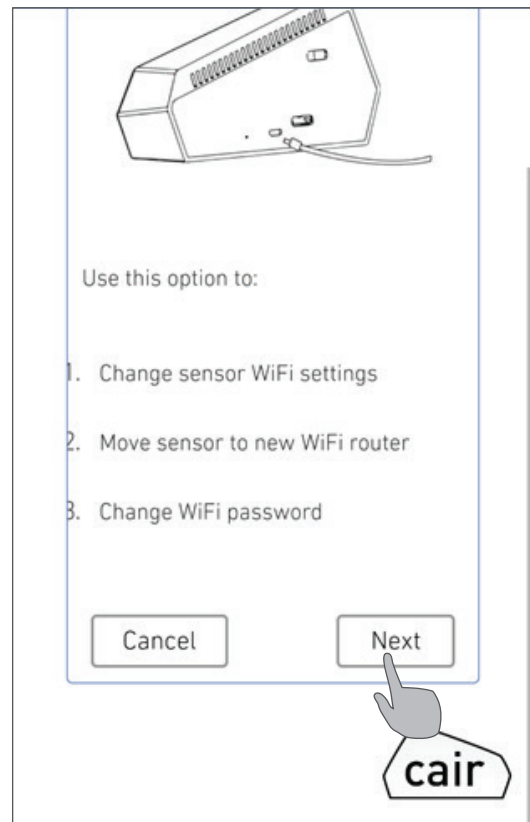

Step 6:  
The instructions screen  
will appear. You will now  
need to leave the app and  
connect to your cair sensor  
by connecting to the  
NuWaveSensor Wi-Fi  
network. Once this is  
completed you can return  
to the app.

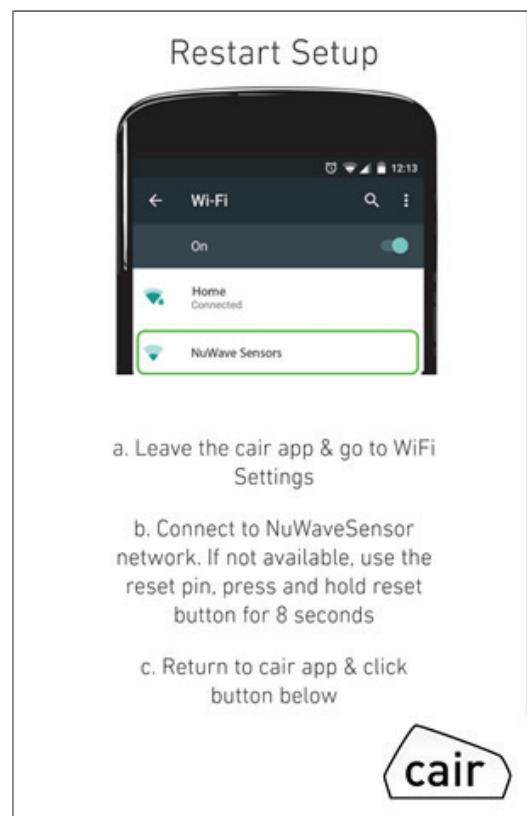

**Step 7:**  
 Select NuWaveSensor  
 from the list and select  
 it to connect to it.

**Note:** If you do not see  
 'NuwaveSensor' on your  
 list of Wi-Fi networks  
 your sensor may not be  
 correctly reset. Please  
 see Step 1 again to  
 re-attempt to reset the  
 sensor.

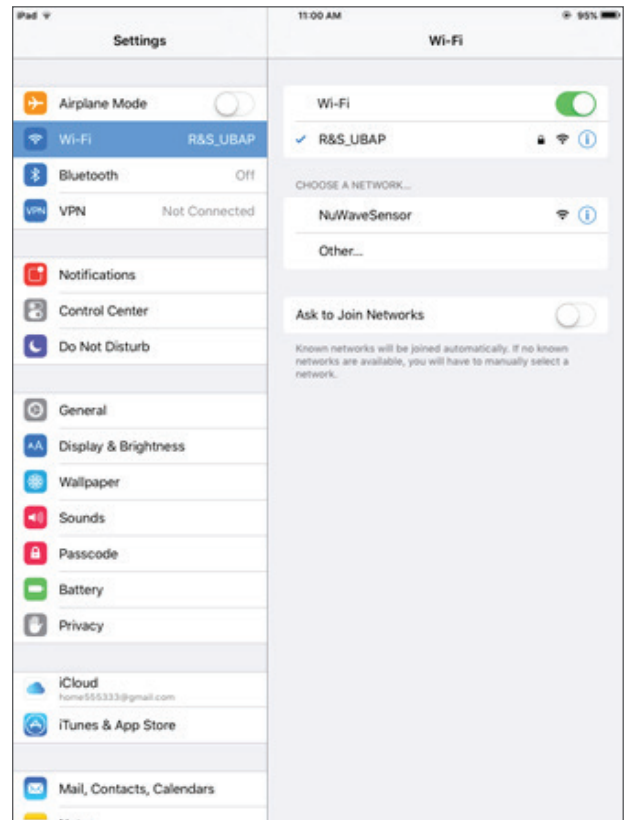

You should see the  
 network status as  
 'connected'

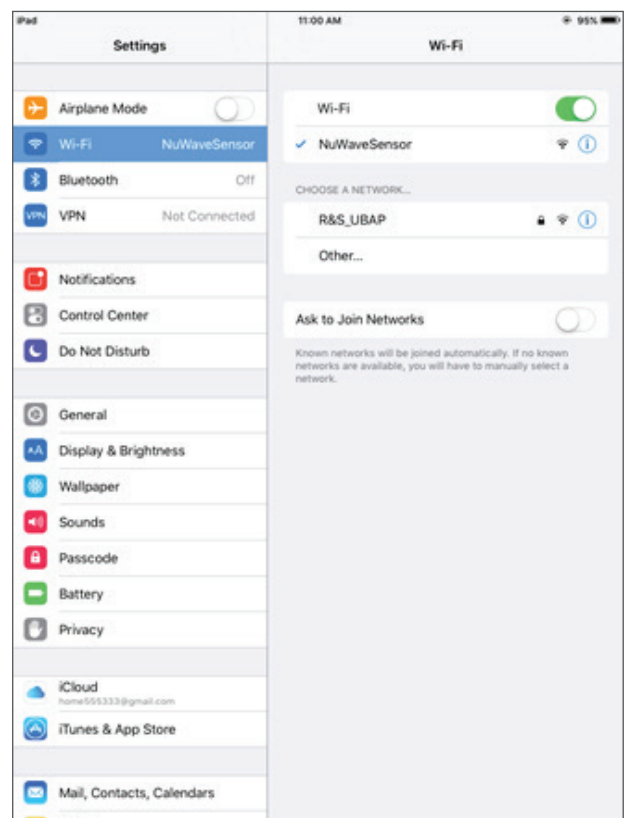



Step 8:  
Select your Wi-Fi  
network from the  
list and press 'Next'

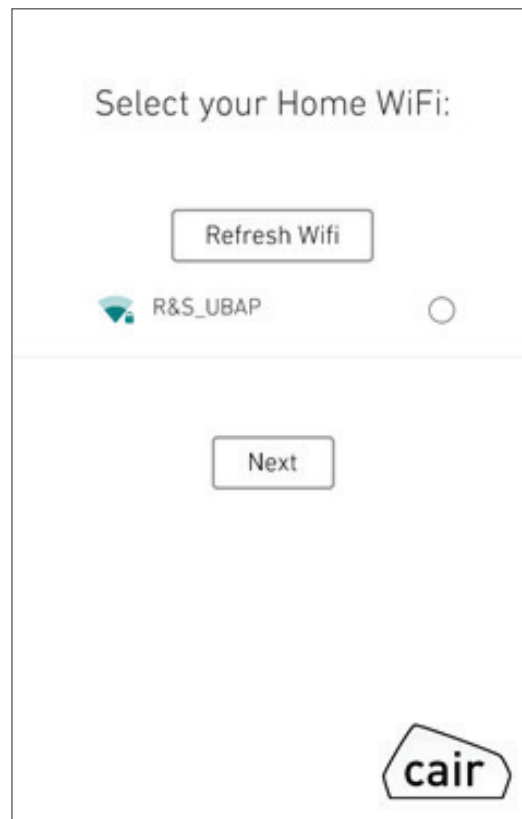

Once selected, you will  
be prompted to enter  
your Wi-Fi password.  
Enter this and press  
'Next'

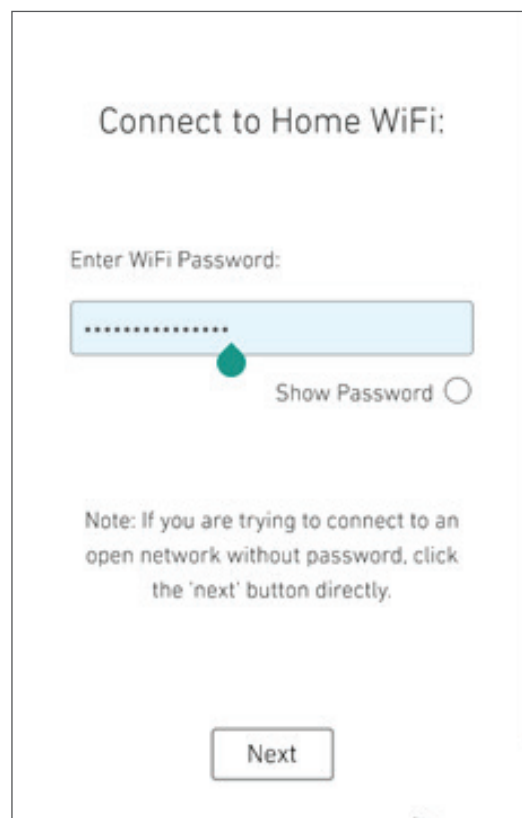

Step 9:  
The App will now  
automatically connect  
to your Wi-Fi network

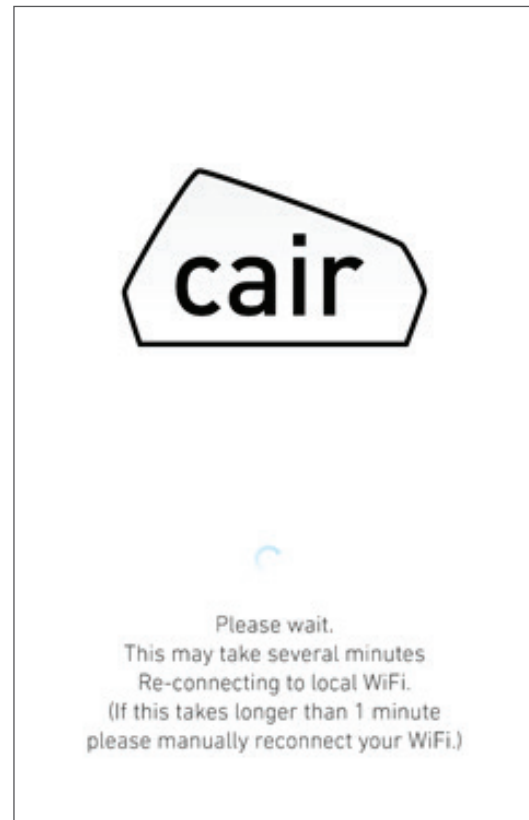

You should see the  
following message  
once it has completed.  
As you have re-connected  
it will take 5 minutes to  
display data on your app  
dashboard.



### Part 3: Sensor Reset Guide

Perform a reset while the device is powered ON

Using the reset pin provided – insert the pin and press and hold the reset button for 8 seconds.

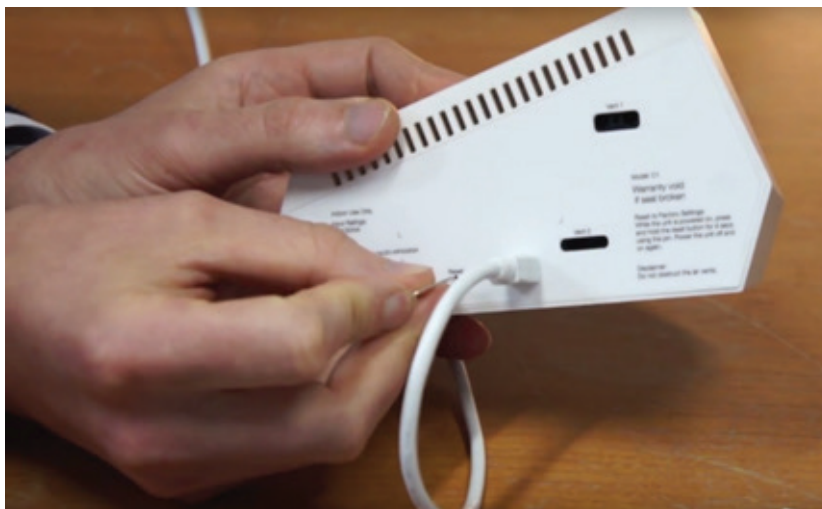

Once this has been completed power the device off and on by unplugging it and plugging it in again.

Your sensor should now be reset. The LEDS on the sensor should start to blink Green and you should see NuWaveSensor listed on the list of available Wi-Fi networks;

